

Nome		Estrutura		Fundação		Base		Base Mt	
Nome	Seção	X	Y	Carga Máx	Carga Mín	M Máx	M Mín	h	h
P1	14x30	207.50	2384.50	2.25	1.00	0.00	0.00	30	55
P2	14x30	207.50	2384.50	2.25	1.00	0.00	0.00	30	55
P3	14x30	207.50	2384.50	2.25	1.00	0.00	0.00	30	55
P4	14x30	207.50	2384.50	2.25	1.00	0.00	0.00	30	55
P5	14x30	207.50	2384.50	2.25	1.00	0.00	0.00	30	55
P6	14x30	207.50	2384.50	2.25	1.00	0.00	0.00	30	55
P7	14x30	207.50	2384.50	2.25	1.00	0.00	0.00	30	55
P8	14x30	207.50	2384.50	2.25	1.00	0.00	0.00	30	55
P9	14x30	207.50	2384.50	2.25	1.00	0.00	0.00	30	55
P10	14x30	207.50	2384.50	2.25	1.00	0.00	0.00	30	55
P11	14x30	207.50	2384.50	2.25	1.00	0.00	0.00	30	55
P12	14x30	207.50	2384.50	2.25	1.00	0.00	0.00	30	55
P13	14x30	207.50	2384.50	2.25	1.00	0.00	0.00	30	55
P14	14x30	207.50	2384.50	2.25	1.00	0.00	0.00	30	55
P15	14x30	207.50	2384.50	2.25	1.00	0.00	0.00	30	55
P16	14x30	207.50	2384.50	2.25	1.00	0.00	0.00	30	55
P17	14x30	207.50	2384.50	2.25	1.00	0.00	0.00	30	55
P18	14x30	207.50	2384.50	2.25	1.00	0.00	0.00	30	55
P19	14x30	207.50	2384.50	2.25	1.00	0.00	0.00	30	55
P20	14x30	207.50	2384.50	2.25	1.00	0.00	0.00	30	55
P21	14x30	207.50	2384.50	2.25	1.00	0.00	0.00	30	55
P22	14x30	207.50	2384.50	2.25	1.00	0.00	0.00	30	55
P23	14x30	207.50	2384.50	2.25	1.00	0.00	0.00	30	55
P24	14x30	207.50	2384.50	2.25	1.00	0.00	0.00	30	55
P25	14x30	207.50	2384.50	2.25	1.00	0.00	0.00	30	55
P26	14x30	207.50	2384.50	2.25	1.00	0.00	0.00	30	55
P27	14x30	207.50	2384.50	2.25	1.00	0.00	0.00	30	55
P28	14x30	207.50	2384.50	2.25	1.00	0.00	0.00	30	55
P29	14x30	207.50	2384.50	2.25	1.00	0.00	0.00	30	55
P30	14x30	207.50	2384.50	2.25	1.00	0.00	0.00	30	55
P31	14x30	207.50	2384.50	2.25	1.00	0.00	0.00	30	55
P32	14x30	207.50	2384.50	2.25	1.00	0.00	0.00	30	55
P33	14x30	207.50	2384.50	2.25	1.00	0.00	0.00	30	55
P34	14x30	207.50	2384.50	2.25	1.00	0.00	0.00	30	55
P35	14x30	207.50	2384.50	2.25	1.00	0.00	0.00	30	55
P36	14x30	207.50	2384.50	2.25	1.00	0.00	0.00	30	55
P37	14x30	207.50	2384.50	2.25	1.00	0.00	0.00	30	55
P38	14x30	207.50	2384.50	2.25	1.00	0.00	0.00	30	55
P39	14x30	207.50	2384.50	2.25	1.00	0.00	0.00	30	55
P40	14x30	207.50	2384.50	2.25	1.00	0.00	0.00	30	55
P41	14x30	207.50	2384.50	2.25	1.00	0.00	0.00	30	55
P42	14x30	207.50	2384.50	2.25	1.00	0.00	0.00	30	55
P43	14x30	207.50	2384.50	2.25	1.00	0.00	0.00	30	55
P44	14x30	207.50	2384.50	2.25	1.00	0.00	0.00	30	55
P45	14x30	207.50	2384.50	2.25	1.00	0.00	0.00	30	55
P46	14x30	207.50	2384.50	2.25	1.00	0.00	0.00	30	55
P47	14x30	207.50	2384.50	2.25	1.00	0.00	0.00	30	55
P48	14x30	207.50	2384.50	2.25	1.00	0.00	0.00	30	55
P49	14x30	207.50	2384.50	2.25	1.00	0.00	0.00	30	55
P50	14x30	207.50	2384.50	2.25	1.00	0.00	0.00	30	55
P51	14x30	207.50	2384.50	2.25	1.00	0.00	0.00	30	55
P52	14x30	207.50	2384.50	2.25	1.00	0.00	0.00	30	55
P53	14x30	207.50	2384.50	2.25	1.00	0.00	0.00	30	55
P54	14x30	207.50	2384.50	2.25	1.00	0.00	0.00	30	55
P55	14x30	207.50	2384.50	2.25	1.00	0.00	0.00	30	55
P56	14x30	207.50	2384.50	2.25	1.00	0.00	0.00	30	55
P57	14x30	207.50	2384.50	2.25	1.00	0.00	0.00	30	55
P58	14x30	207.50	2384.50	2.25	1.00	0.00	0.00	30	55
P59	14x30	207.50	2384.50	2.25	1.00	0.00	0.00	30	55
P60	14x30	207.50	2384.50	2.25	1.00	0.00	0.00	30	55
P61	14x30	207.50	2384.50	2.25	1.00	0.00	0.00	30	55
P62	14x30	207.50	2384.50	2.25	1.00	0.00	0.00	30	55
P63	14x30	207.50	2384.50	2.25	1.00	0.00	0.00	30	55
P64	14x30	207.50	2384.50	2.25	1.00	0.00	0.00	30	55
P65	14x30	207.50	2384.50	2.25	1.00	0.00	0.00	30	55
P66	14x30	207.50	2384.50	2.25	1.00	0.00	0.00	30	55
P67	14x30	207.50	2384.50	2.25	1.00	0.00	0.00	30	55

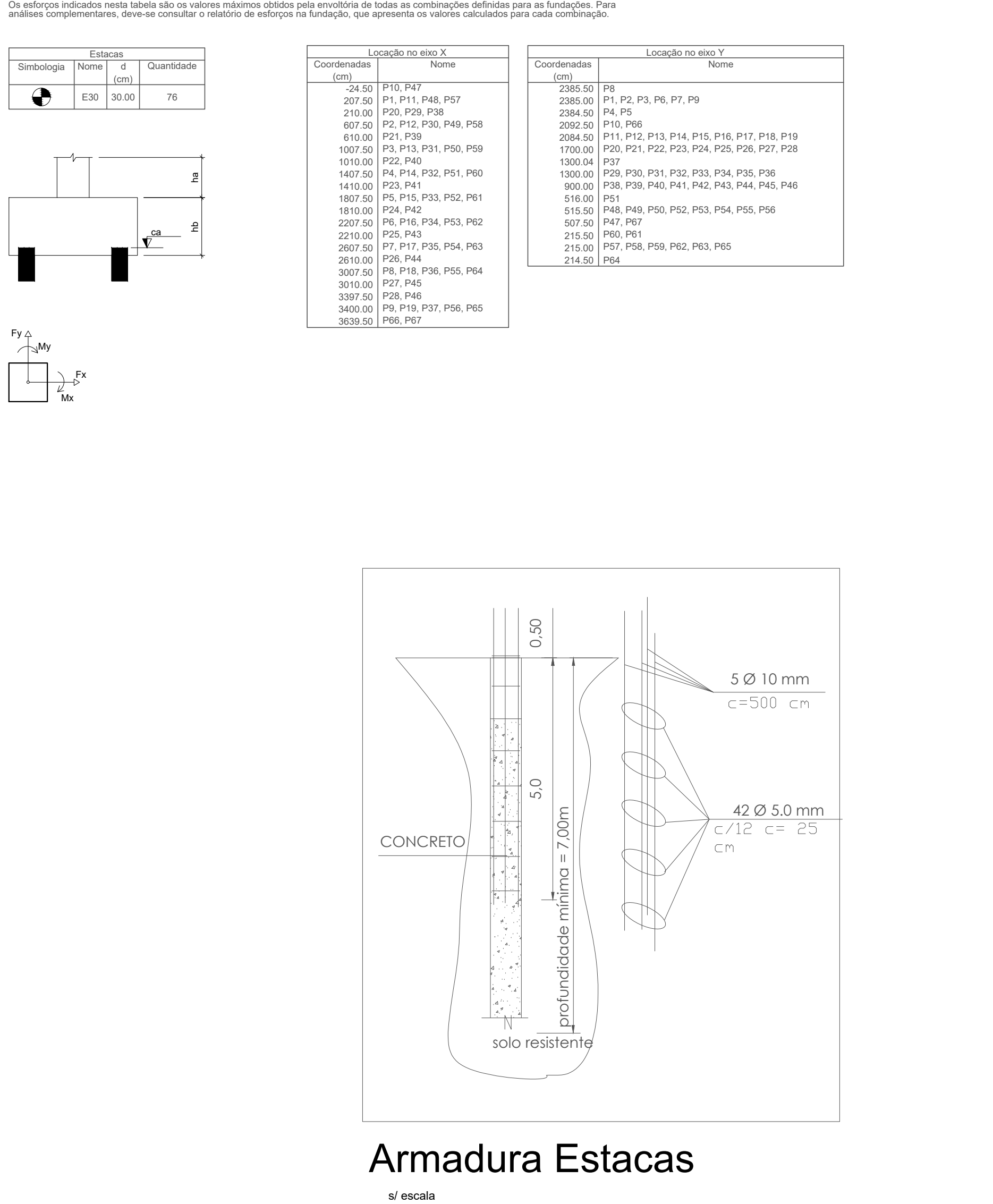

CARIMBO DE APROVAÇÕES:

PROJETO CEASA CATALÃO - ATACADISTA

ENDEREÇO DA OBRA:
ARCO VIÁRIO, KM 2, ZONA RURAL, CATALÃO - GO

PROPRIETÁRIO:
PREFEITURA MUNICIPAL DE CATALÃO - GO

AUTOR DO PROJETO:
ENGP. SAMUEL GONÇALVES CARRILHO

RESPONSÁVEL TÉCNICO:
ENGP. SAMUEL GONÇALVES CARRILHO

DESCRICO:
* Planta de Locação

ESCALA:
INDICADAS

DATA:
13 / 03 / 2023

DESENHO:
SAYONARA

REVISAO:
64) 3443-1688